

enteliBUS™

CONTROL SYSTEM | MODULAR CONTROLLER



enteliBUS™ Control System | Modular Controller

Introducing enteliBUS™

The enteliBUS Control System is a fully-programmable, native BACnet® control platform. Its modular design with expandable I/O provides unparalleled flexibility covering a wide range of control applications from low-density distributed I/O through high-density centralized I/O. As a BACnet Router, enteliBUS supports multiple communication methods including BACnet/IP, BACnet over Ethernet, BACnet MS/TP, Delta LINKnet and Modbus RTU (optional).

enteliBUS Features

Modular: The enteliBUS Control System is a modular system of components that you select to meet the exact needs of a wide range of HVAC and Access control applications. Modularity offers unparalleled flexibility, allowing you to choose the specific I/O required for your current application, while the ease of expansion allows you to increase your I/O count as needed in the future. Modular components also simplifies control system servicing. Should any component become damaged you need to replace a single module only, not the entire controller.

Expandable: Since you can add as many or as few I/O Modules as required for your application, the enteliBUS Control System is scalable and cost effective over a wide range of applications, from low-density distributed control through high-density centralized I/O applications.

Flexible: Because the enteliBUS system is made up of modular components it provides unparalleled flexibility. With a selection of I/O modules supporting all typical input and output types, it is easy to create the exact quantity and mix of inputs and outputs required for virtually any control application. This means you pay only for the I/O you require.

Compact Footprint: The enteliBUS system has a compact footprint, minimizing space usage in confined areas and mounts easily onto standard DIN rail.

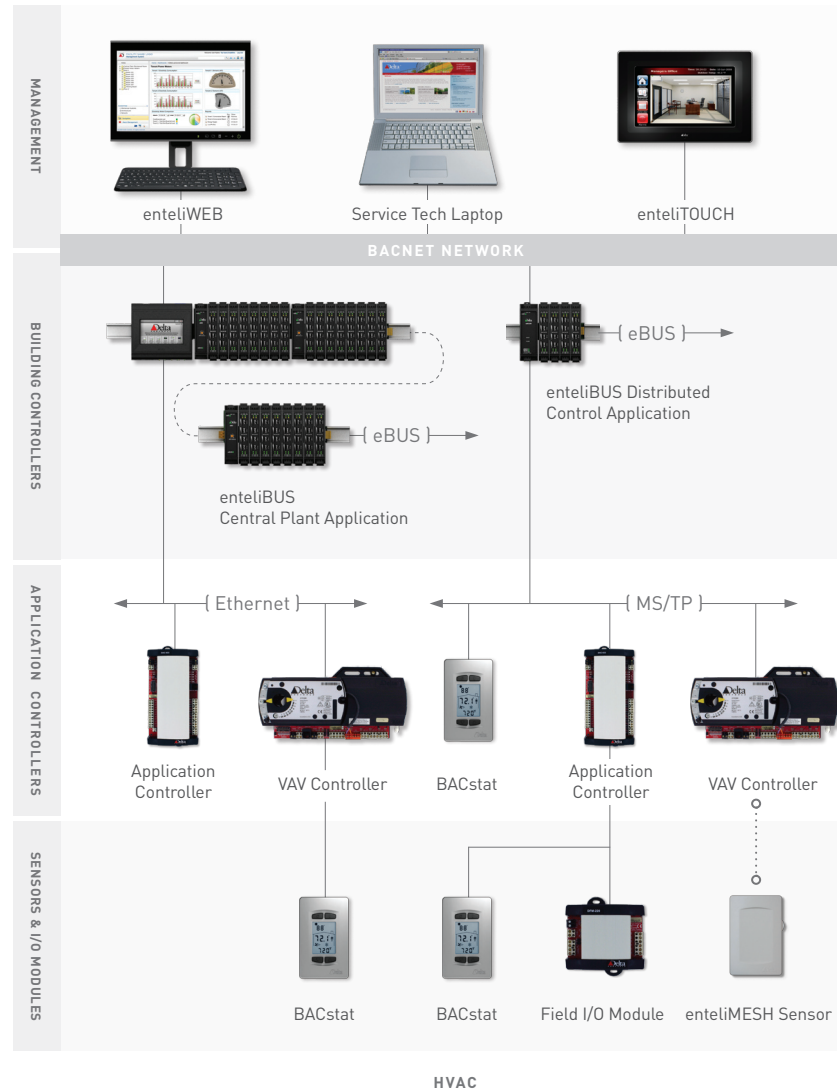

enteliBUS Control System

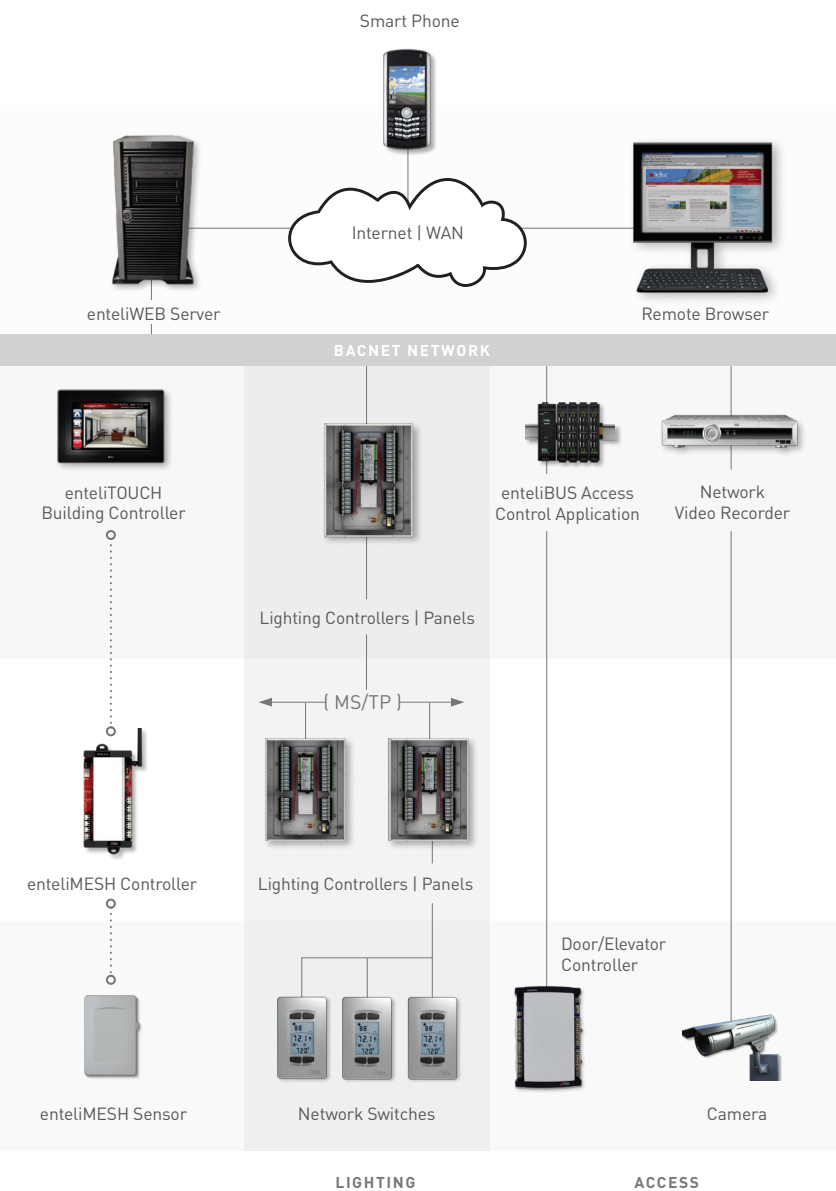

enteliBUS Control System

enteliBUS Applications

Central Plants: The high-density I/O capabilities of the enteliBUS platform make it ideal for large central plant applications. In this application centralizing I/O is cost efficient, provides better control, and is typically easier to engineer and program when compared to distributed control architectures.

Distributed Control: The enteliBUS Control System can also be configured for low- to medium-density, distributed control applications where the mechanical equipment is located throughout the facility rather than centralized. In these applications it is more cost effective to use several local controllers networked together rather than pulling all point wiring back to a central location.

System Manager/BACnet Router: In addition to providing control for its local I/O, enteliBUS Automation Engines support multiple communication ports and protocols, and can act as a BACnet Router for one or more subnets of controllers. These subnets could be for zone control of applications such as VAVs, Fan Coils, Heat Pumps, Radiation etc., Lighting Panel controllers, or Access Elevator/Door Controllers.

BACnet Integration: The enteliBUS Control System is a fully-programmable Native BACnet building controller platform. It integrates seamlessly with Delta's existing line of BACnet controllers and software, providing a powerful yet user-friendly control solution for today's intelligent buildings.

Delta Controls is a proven leader in BACnet integration. All of our products are put through BACnet compliance testing at independent testing laboratories ensuring easy integration into multi-vendor BACnet installations.

enteliBUS™ Control System | Modular Controller



Automation Engines

Automation Engine Modules contain the primary CPU, and system memory. They monitor, store and execute the control logic, which is sent to the I/O Modules through the enteliBUS Backplanes.

There are two versions of Automation Engines, standard and compact. The standard version has an LCD touch screen interface option and supports more communication ports than the compact model.



- Fully Programmable Native BACnet Building Controller
- BACnet/IP, BACnet over Ethernet, BACnet MS/TP, Delta LINKnet & Modbus RTU (optional) communications
- SD Card Memory Expansion & USB Ports

- Inputs: 0-5VDC, 0-10VDC, 4-20mA, 10k thermistor, 1k RTD, and Dry contact
- Outputs: 0-10VDC, 24VAC TRIAC, and NO relay
- Optional monitored overrides (3-position switches and analog 0-100% levers)

I/O Modules

I/O Modules come in various configurations supporting all common control types. Auto detecting and hot-swappable I/O Modules are selected to provide the exact I/O combination needed for a given application.

- Up to eight points per I/O Module

To learn more about enteliBUS™ or any of Delta Controls' enteliSYSTEM™ products, please contact us online at deltacontrols.com.

